

ZONE	REV	SCR NO.	DESCRIPTION	BY	DATE	APPROVED
-	-	29475	NEW RELEASE	JV	11/29/99	D. Provencher
-	A	32560	ADDED ADVANCE MATE SHIELD	JSG	5/7/01	LEBLANC
-	B	39370	ADDED VHDW TO TITLE	SG	8/01/02	TEH
-	C	40819	MODIFIED TABLE III	SG	1/17/03	W.LI
-	D	41020	ADDED TABLE V AND NOTE 9	SG	1/27/03	W.LI
-	E	WL11-5V6MM.V001	ADDED TABLE VI AND REVISED DATUMS	SG	1/30/04	W.LI
-	F	KLEC-668NLR.V001	ADDED 467-X105-XXX PART OPTION	JSG	7/29/04	LEBLANC
-	G	KLEC-668SE5.V001	ADDED NOTES 17 & 18	SG	9/20/04	LEBLANC
-	H	DMAG-68SM1Q.V001	ADDED LEAD FREE PLATING OPTION	GKR	05/03/05	S. BAIK
-	J	MLEC-6G6MF.U.V001	REPLACED DRAWING FORMAT	M.LEE	12/27/05	C. SAMMIS
-	K	SBAR-6NHL4J.V001	UPDATED TABLE 2, TABLE 3 AND TABLE 6	HCL	04/11/06	K. LEBLANC

BACKPLANE GUIDANCE/POLARIZING MODULE ASSEMBLY PART NUMBER ASSIGNMENT

- 2 - CUSTOM LOAD, LEAD FREE
 - 3 - L-SERIES
 - 5 - UNIFORM LOAD, 702X
 - 6 - UNIFORM LOAD, BRUSH 60
 - 7 - CUSTOM LOAD, LEADED
 - 8 - ADVANCE MATE, UNIFORM LOAD 702X
 - 9 - ADVANCE MATE, UNIFORM LOAD BRUSH
- CONTACT LOAD (PIN LENGTH)
- | | |
|---|--------|
| 1 | = 4.75 |
| 2 | = 6.25 |
| 3 | = 4.25 |
| 4 | = 5.15 |
- PLATING CODE
- | | | | |
|---|-------|---|-------|
| 0 | = 735 | 2 | = 769 |
| 1 | = 732 | 3 | = 768 |
- POLARIZING PIN LOCATION CODE (SEE TABLE)
- NO. OF POSN
- | | |
|----|-----------|
| 5 | = 5 POSN |
| 10 | = 10 POSN |
| 25 | = 25 POSN |

TABLE I

ASSEMBLY PART NUMBER	BACKPLANE GUIDANCE POLARIZING MODULE	K	(L)	P	TOTAL NUMBER OF SIGNAL CONTACTS	TOTAL NUMBER OF GROUND SHIELD
467-X110-XXX	467-0110-070	9	(18.00)	27.0	40	10
467-X125-XXX	467-0125-070	24	(48.00)	57.0	100	25
467-X105-XXX	467-0105-070	4	(8.00)	17.0	20	5

TABLE II

ASSEMBLY PART NUMBER	SIGNAL CONTACTS	CONTACT LENGTH
467-(3,5,8)1XX-XX1	260-0022-⑦	4.75
467-(3,5,8)1XX-XX2	260-0021-⑦	6.25
467-(3,5,8)1XX-XX3	260-0023-⑦	4.25
467-(3,5,8)1XX-XX4	260-0024-⑦	5.15
467-(6,9)1XX-XX1	260-0002-⑦	4.75
467-(6,9)1XX-XX2	260-0001-⑦	6.25
467-(6,9)1XX-XX3	260-0003-⑦	4.25
467-(6,9)1XX-XX4	260-0004-⑦	5.15

TABLE III

ASSEMBLY PART NUMBER	SHIELD CONTACTS SEE DETAIL W SH 2	SHIELD LENGTH
467-31XX-XXX	N/A	N/A
467-51XX-XXX	272-0021-⑦	5.3
467-61XX-XXX	272-0001-⑦	5.3
467-81XX-XXX	272-0024-⑦	5.5
467-91XX-XXX	272-0004-⑦	5.5

TABLE V

GUIDE AND POL PIN	PART NUMBER	N	P
STANDARD GUIDE PIN	564-0385-553	19.3	-
CUSTOM GUIDE PIN	564-0420-553	17.3	-
CUSTOM GUIDE PIN	564-0487-553	13.4	-
STANDARD POL PIN	564-0440-553	-	10.4

TABLE VI

ASSEMBLY P/N	REV
467-X1XX-XXX	N

TABLE IV

PART NUMBER 467-X1XX-()	-0XX	-AXX	-BXX	-CXX	-DXX	-EXX	-FXX	-GXX	-HXX
POLARIZING PIN ORIENTATION									

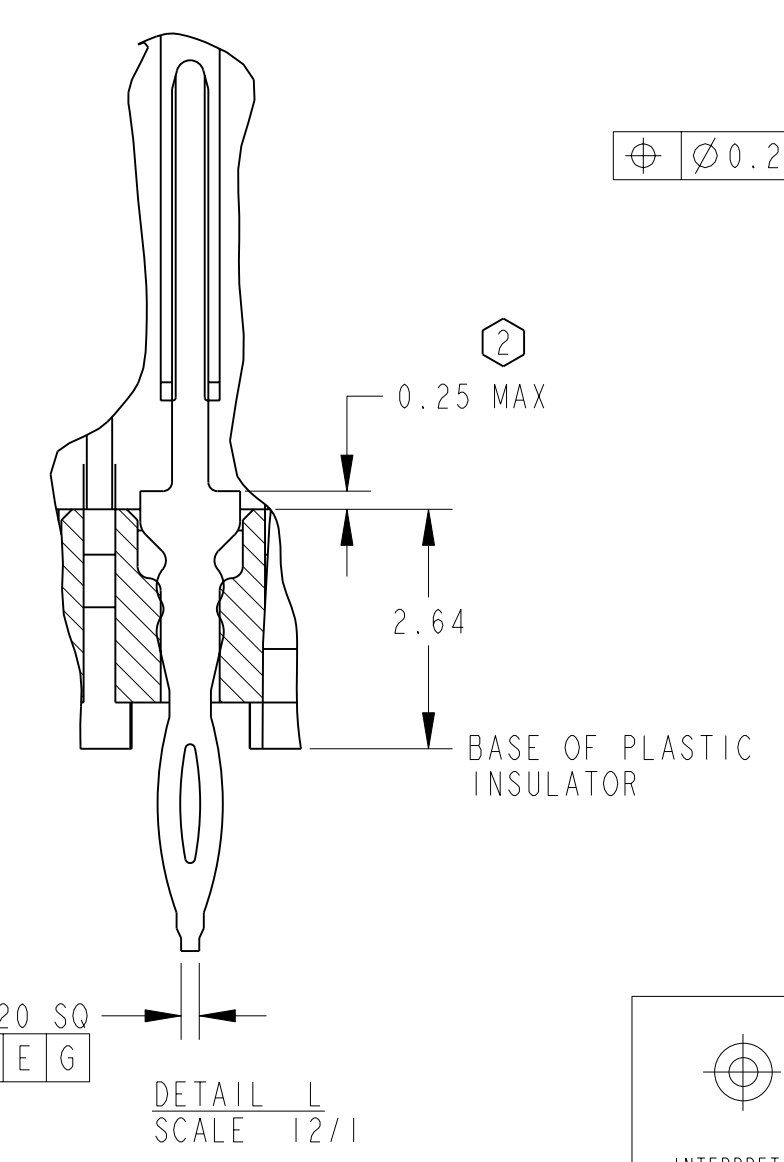
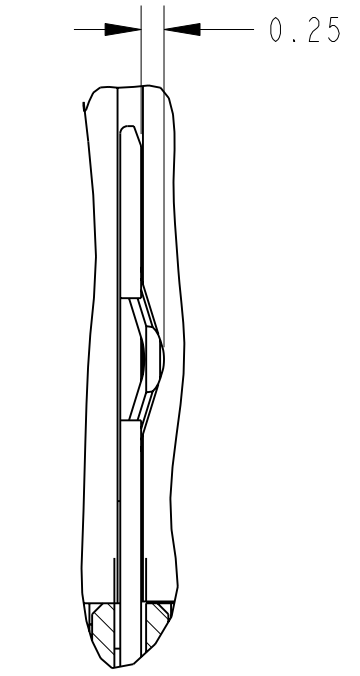
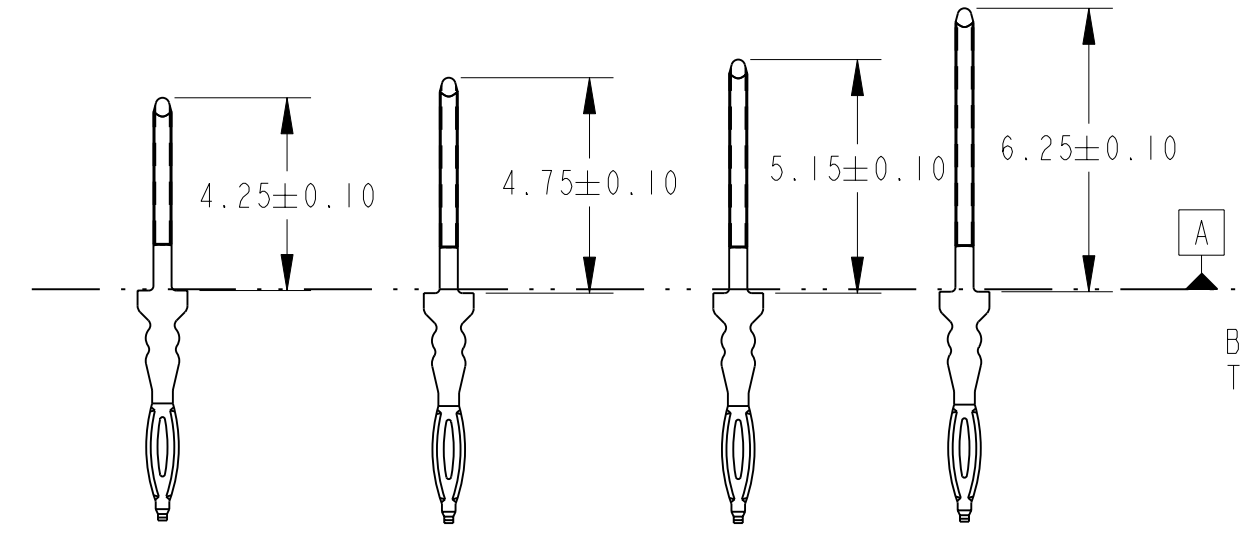
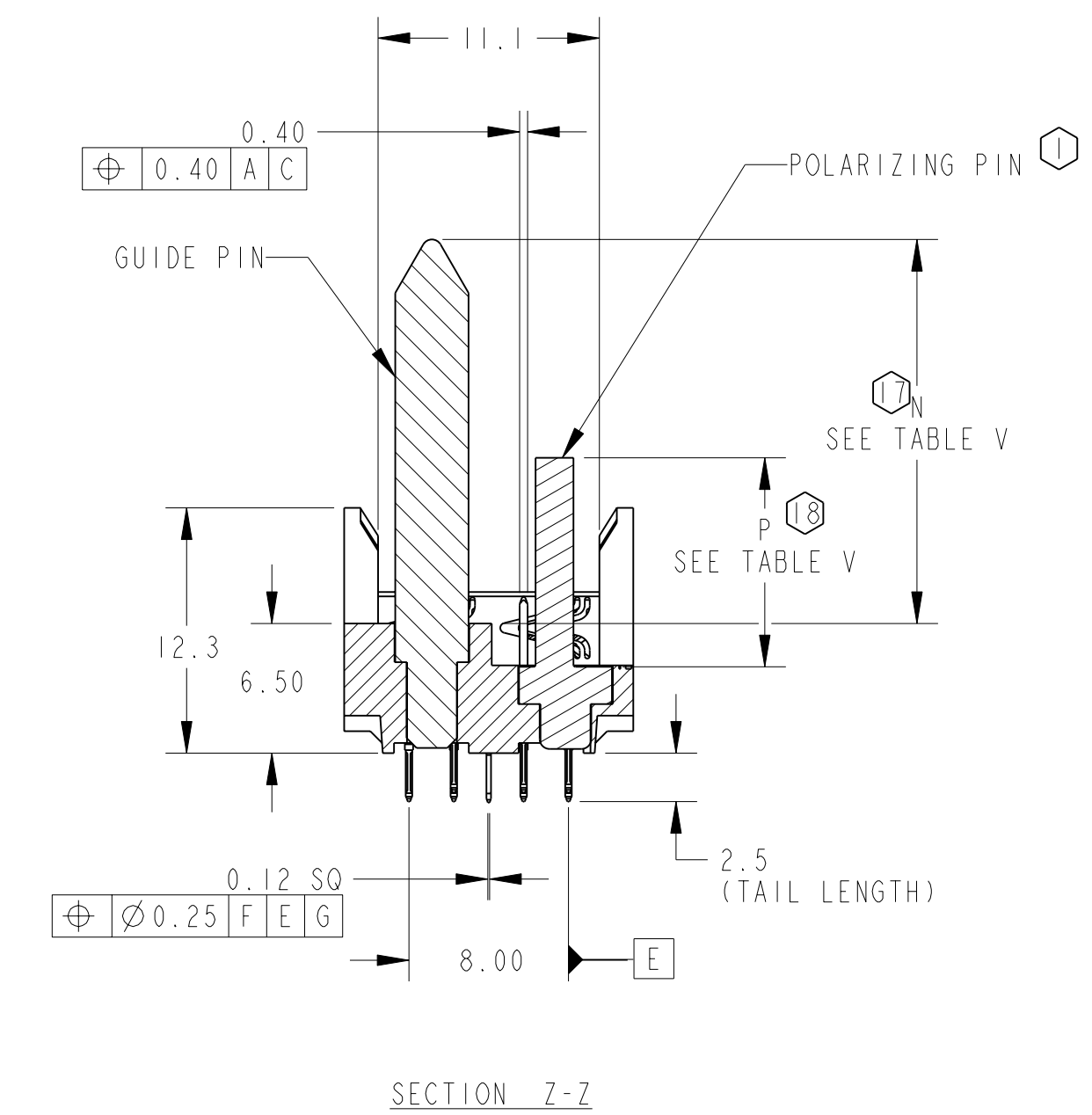
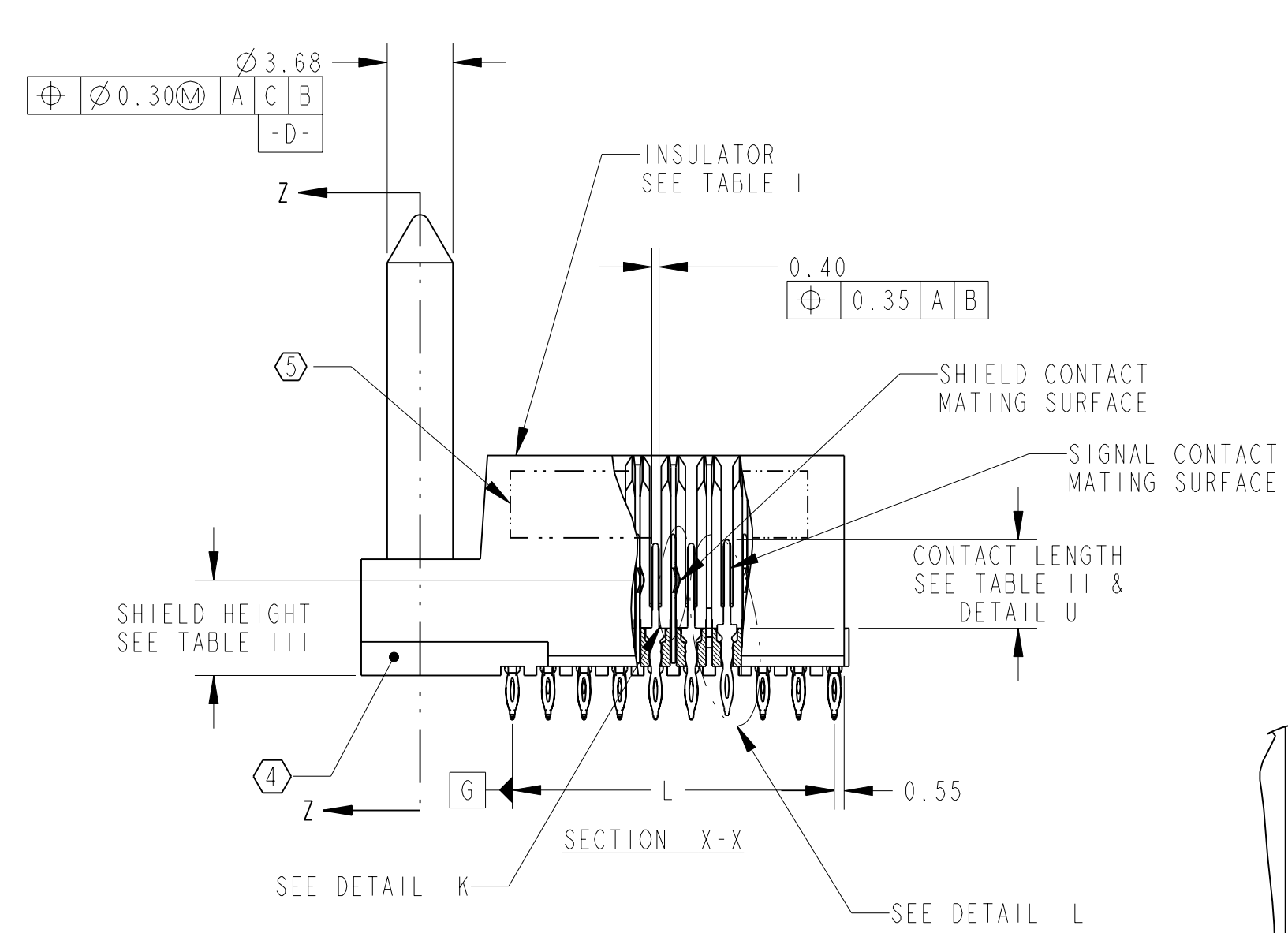
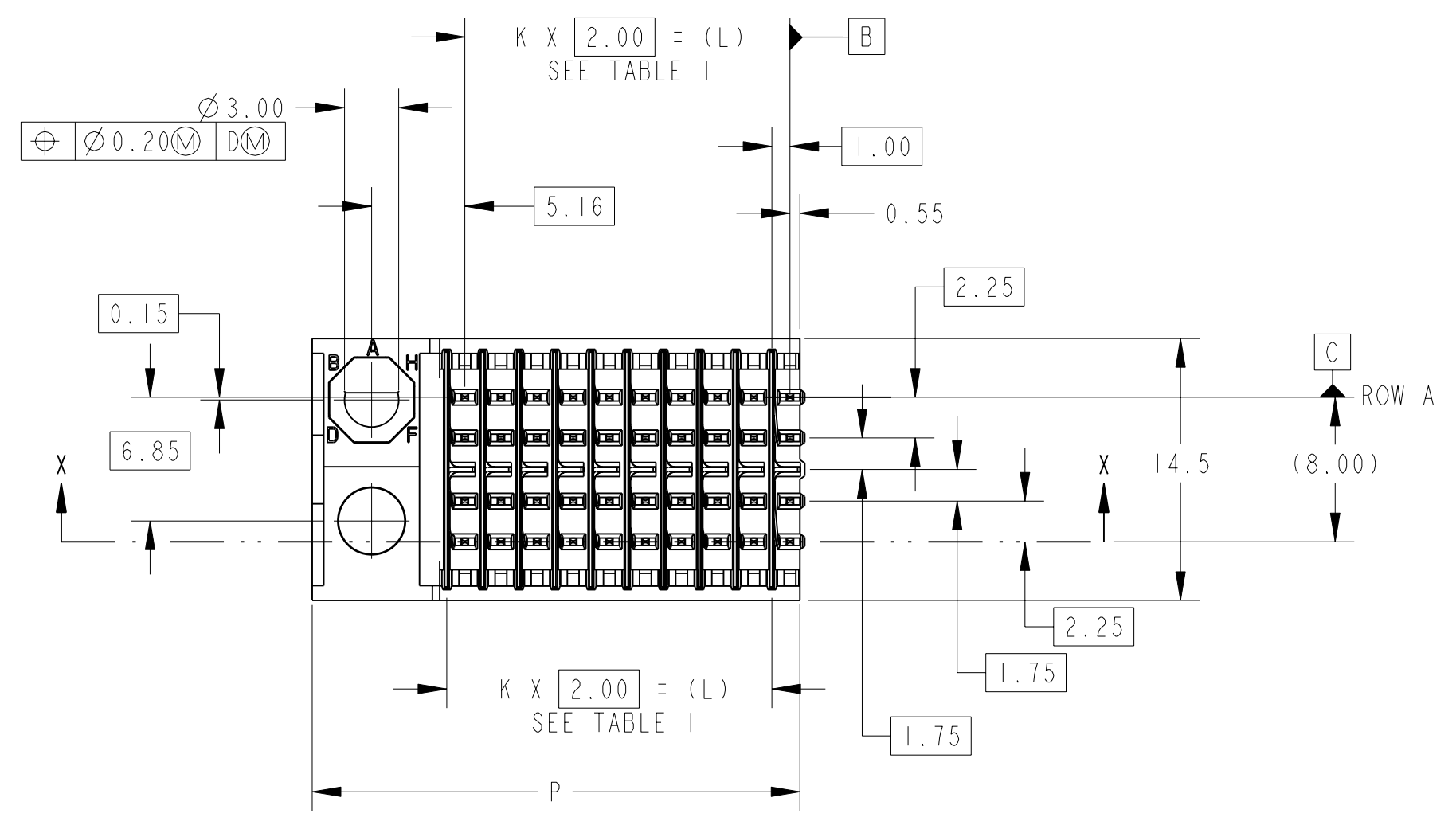

- NOTES:
- POLARIZING PIN MUST ALIGN AS INDICATED BY PART NUMBER CODE (SEE TABLE IV). TO INSURE PROPER ALIGNMENT, THE OCTAGONAL BASE PORTION OF THE PIN MUST BE POSITIONED INTO THE CORRESPONDING MOLDED CAVITY.
 - WHEN ASSEMBLED TO BACKPLANE INSULATOR, CONTACTS MUST SEAT FLUSH WITH INSULATOR'S TOP SURFACE TO A MAXIMUM ALLOWABLE GAP OF 0.25.
 - SHIELD SHALL BE STRAGHT WITH MAXIMUM ALLOWABLE BOW OF 0.15 MILLIMETERS ON EITHER SIDE OF SHIELD. SEE DETAIL X. SEE SHEET 2.
 - OPEN, NOTCH END DESIGNATES COLUMN 1.
 - PART MARKING AS FOLLOWS:
 LINE 1: TCSYYWDH (LOGO, YEAR, WEEK, DAY, HOUR)
 LINE 2: MODULE PART NUMBER (467#####)
 LINE 3: WORK ORDER NUMBER (VH#####) WHERE "*" DENOTES MANUFACTURING LOCATION.
 - IF MODULE PART NUMBER IS 467-7XXX-XXX OR 467-2XXX-XXX, PART REVISION, MODULE ORIENTATION, NUMBER OF COLUMNS, PLATING CODE, AND SIGNAL CONTACT LOAD ARE NOT APPLICABLE.
 - LAST 3 DIGITS OF SIGNAL AND SHIELD CONTACT ARE DETERMINED BY PLATING CODE PER EGS 205.
 - FOR HASL ONLY, PTH TO BE $\phi 0.610 - 0.495$ MILLIMETERS.
 - ROUTE DIFFERENTIAL PAIRS THROUGH A-B AND D-E
 - DATUM -A- IS DEFINED AS THE WAFER MATING SURFACE OF THE PLASTIC INSULATOR.
 - DATUM -B- IS DEFINED AS THE CENTERLINE OF THE TOP OF THE OUTERMOST WAFER SLOTS IN THE INSULATOR WALLS.
 - DATUM -C- IS DEFINED AS THE CENTERLINE OF THE CONNECTOR MEASURED FROM THE TWO OUTERMOST ROWS OF SIGNAL CONTACT HOLES.
 - DATUM -E- IS DEFINED AS THE CENTERLINE OF THE CONNECTOR MEASURED FROM THE TWO OUTERMOST COLUMNS OF SIGNAL CONTACTS TAIL SIDE.
 - DATUM -F- IS DEFINED AS THE BOTTOM SURFACE OF THE PLASTIC INSULATOR.
 - DATUM -G- IS DEFINED AS THE CENTERLINE OF THE CONNECTOR MEASURED FROM THE TWO OUTERMOST ROWS OF SIGNAL CONTACTS TAIL SIDE.
 - ALL PART NUMBERS ARE AT REVISION N, EXCEPT PART NUMBER 467-7XXX-XXX AND 467-2XXX-XXX, UNLESS OTHERWISE SPECIFIED.
 - USING GUIDE PINS THAT ARE SHORTER THAN THE STANDARD HEIGHT OF 19.3mm MAY NOT PROVIDE THE SUFFICIENT X AND Y AXIS ALIGNMENT AND POLARIZING PROTECTION PRIOR TO COMMENCEMENT OF ALL COMPONENT MATING SEQUENCES. CONSULT TERADYNE APPLICATIONS ENGINEERING PRIOR TO SYSTEMS DESIGN AND COMPONENT SELECTION.
 - STANDARD GUIDE PIN (564-0385-553) AND STANDARD POLARIZING PIN (564-0387-540) ARE IN STANDARD 5000 SERIES MODEL ASSEMBLIES. ANY GUIDE PIN OR POLARIZING PIN OTHER THAN THESE STANDARD NUMBERS WILL RESULT IN CUSTOM 7000 SERIES MODULE ASSEMBLIES BEING ASSIGNED.

TOLERANCES

DESIGN	7/7/99
0.0	±0.25
0.00	±0.13
0.000	±
ANGLES	±

DESIGNER: D. Provencher
 DRAWN: D. Provencher
 CHK: D. Provencher
 APVD: 4/27/00

Amphenol TCS
 A Division of Amphenol Corporation
 44 Simon Street, Nashua, NH, 03060 603.879.3000

TITLE: BACKPLANE POLARIZING/GUIDANCE M ASSEMBLY, LEFT, 5 ROW VHDW-HSD

PART NO. SEE TABLE VI

DRAWING NO. C-467-5110-500

PROE ASSEM P1018-ASSY-BP-10-LEFTGUIDE-BRD P1018-BP-LEFT-GUIDE-ASSY.dwg

SCALE: 3.000

SHEET 1 OF 2

INTERPRET PER ASME Y14.5M
 CODE IDENT 31413

CUSTOMER USE DRAWING

DRW NO. C-467-5110-500

SH 1 REV K

ZONE	REV	SCR NUMBER	DESCRIPTION	BY	DATE	APPROVED
ALL			SEE SHEET I			

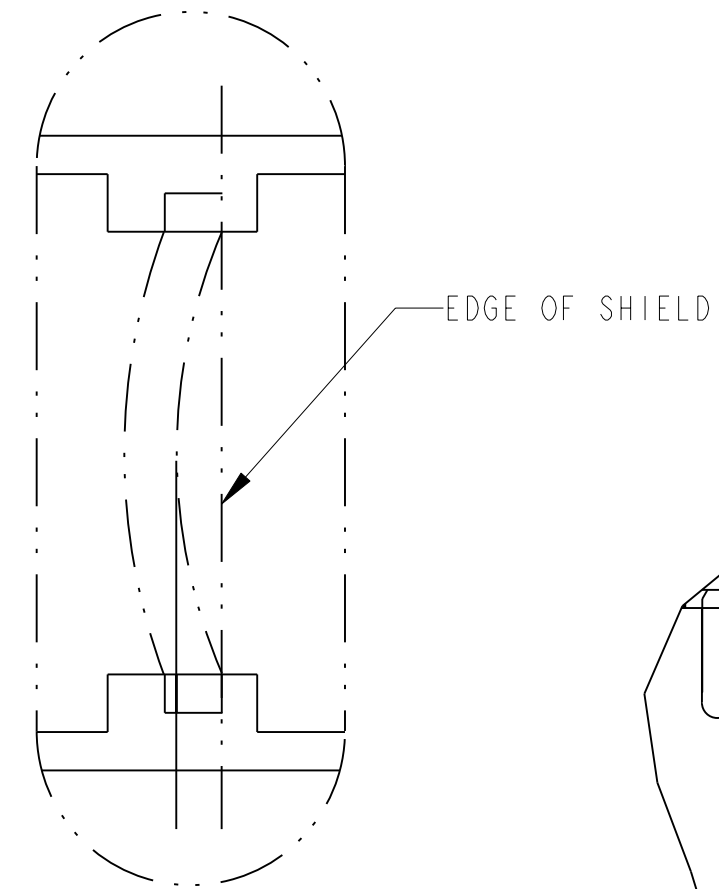
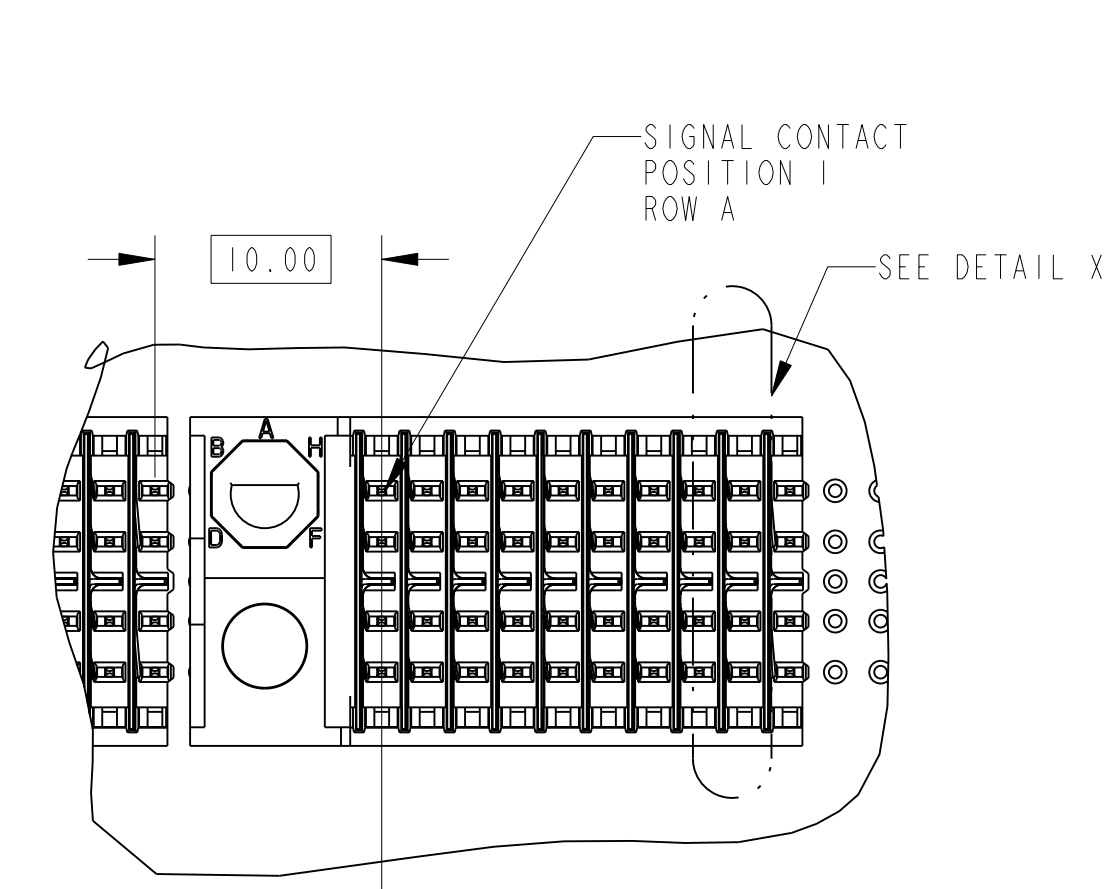

DETAIL X
NO SCALE

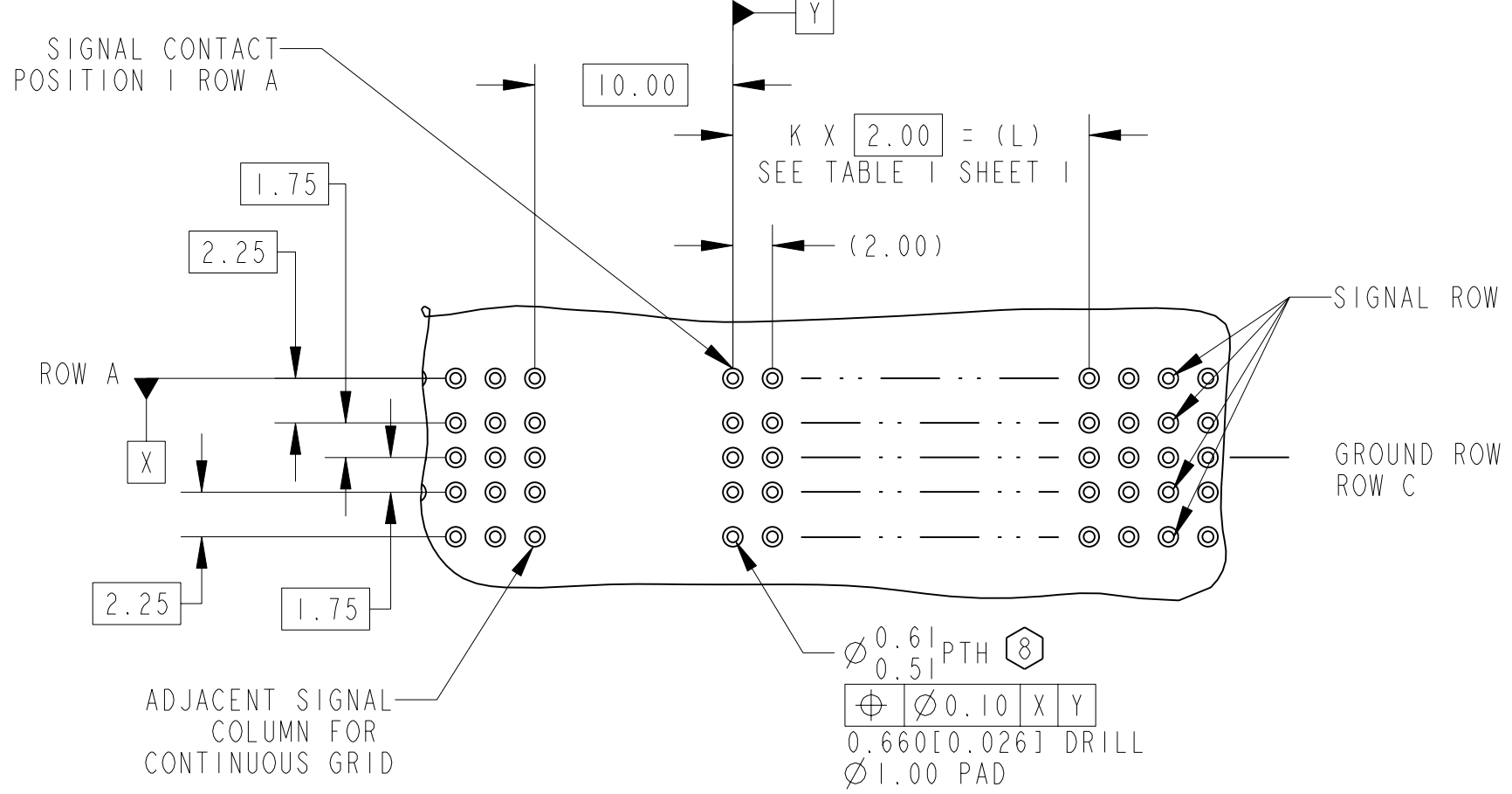
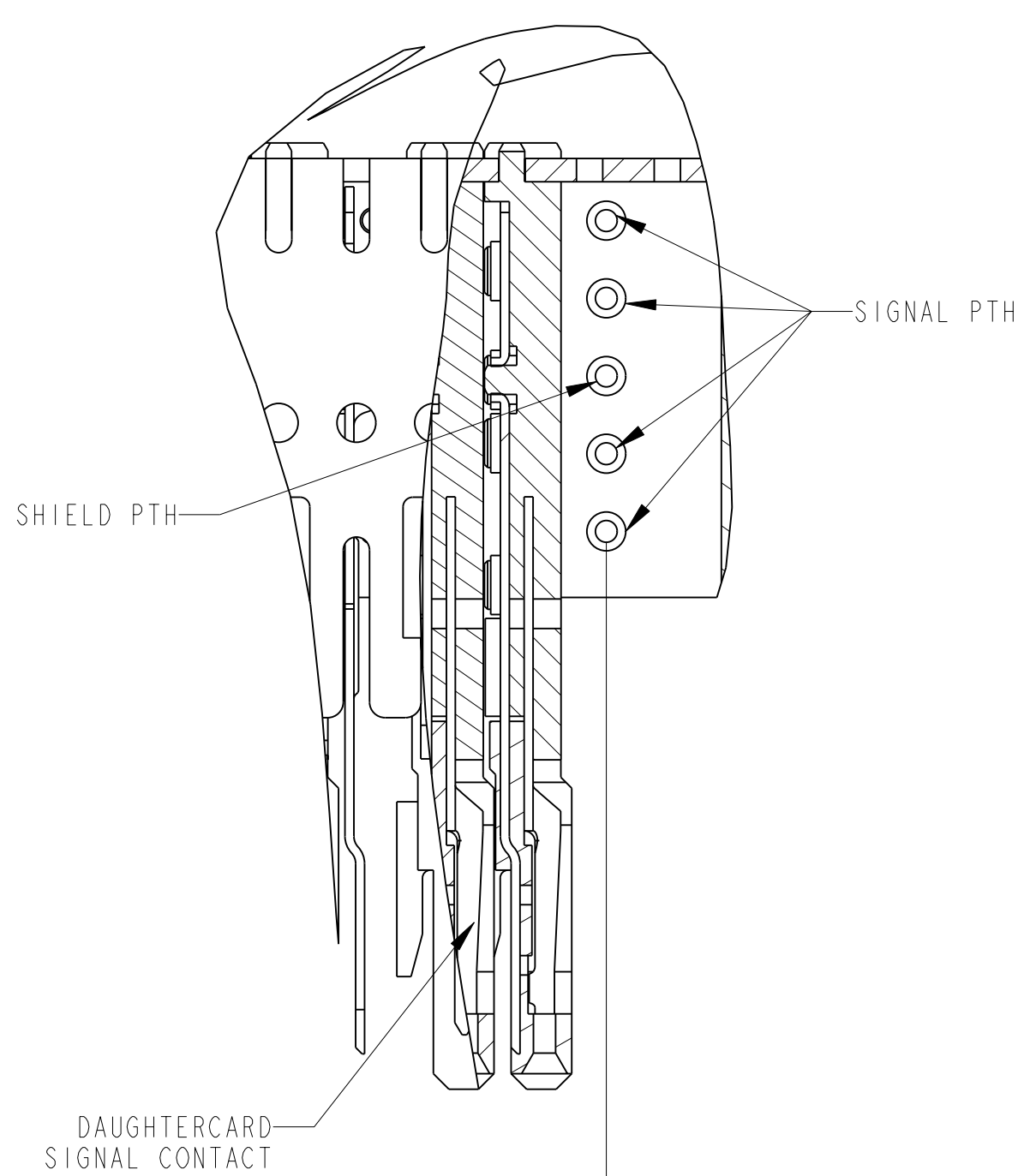

BACKPLANE HOLE PATTERN
SIGNAL WITH GUIDANCE
CONNECTOR SIDE

0.6 PTH (8)
0.5
Ø 0.10 X Y
0.660 [0.026] DRILL
Ø 1.00 PAD

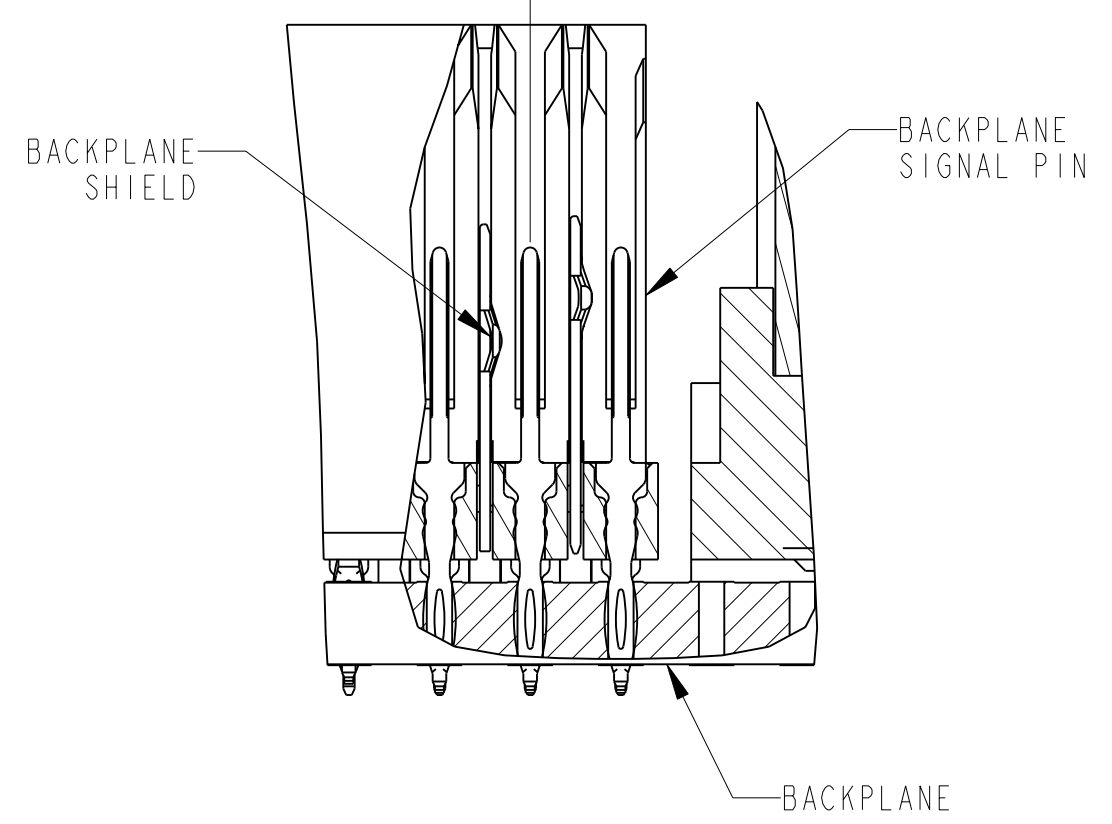
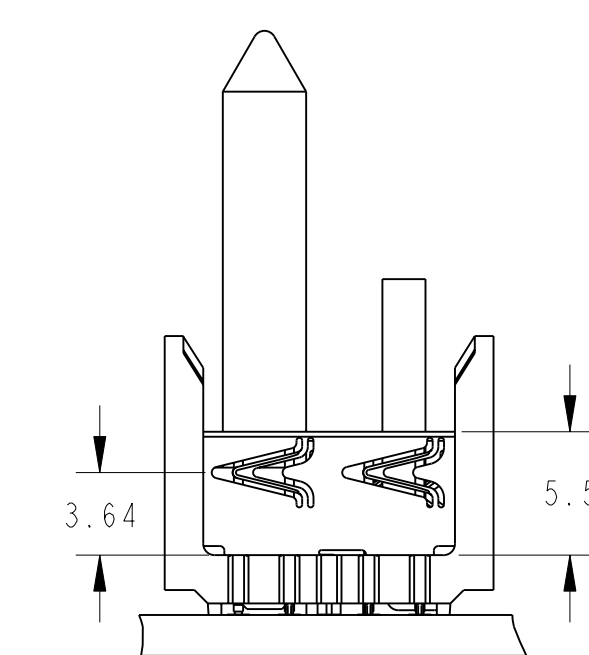
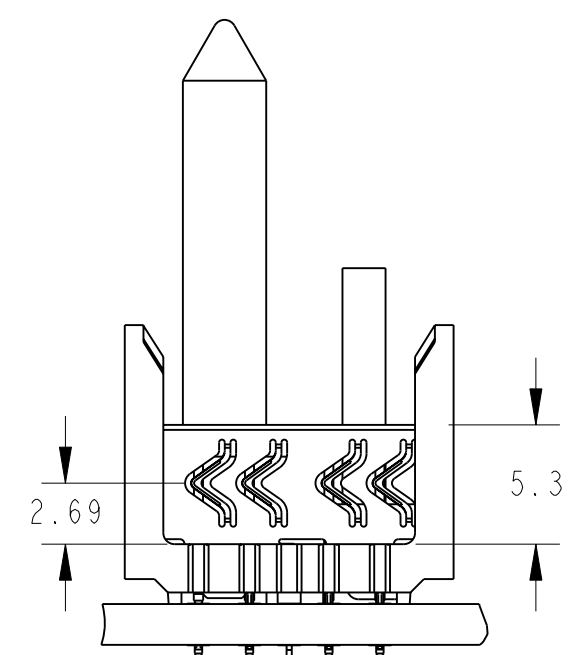
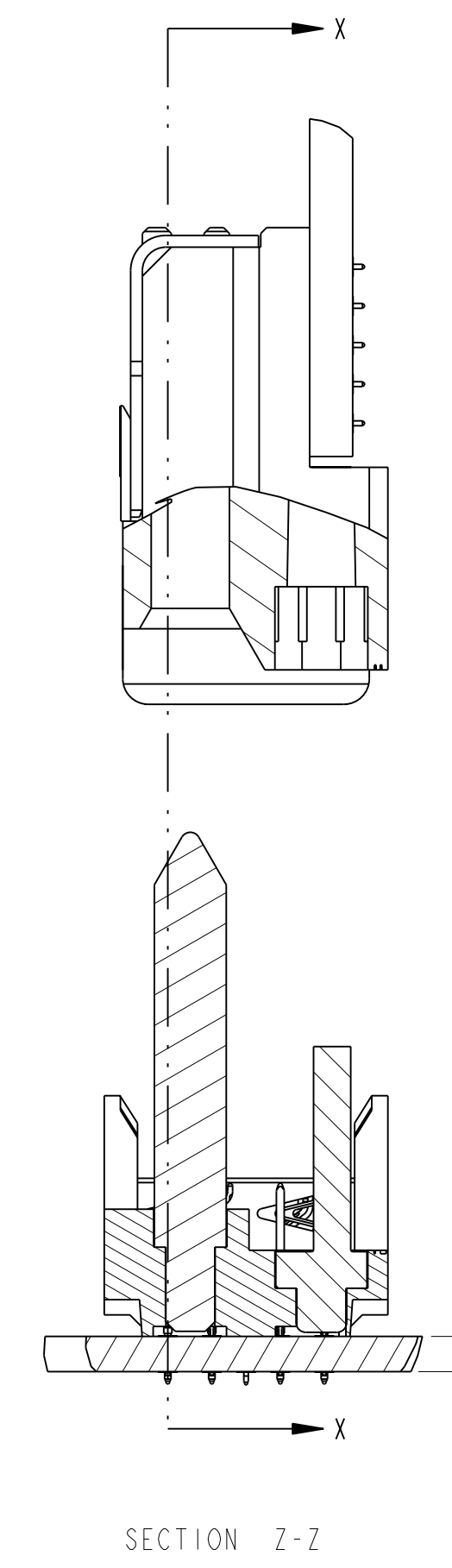
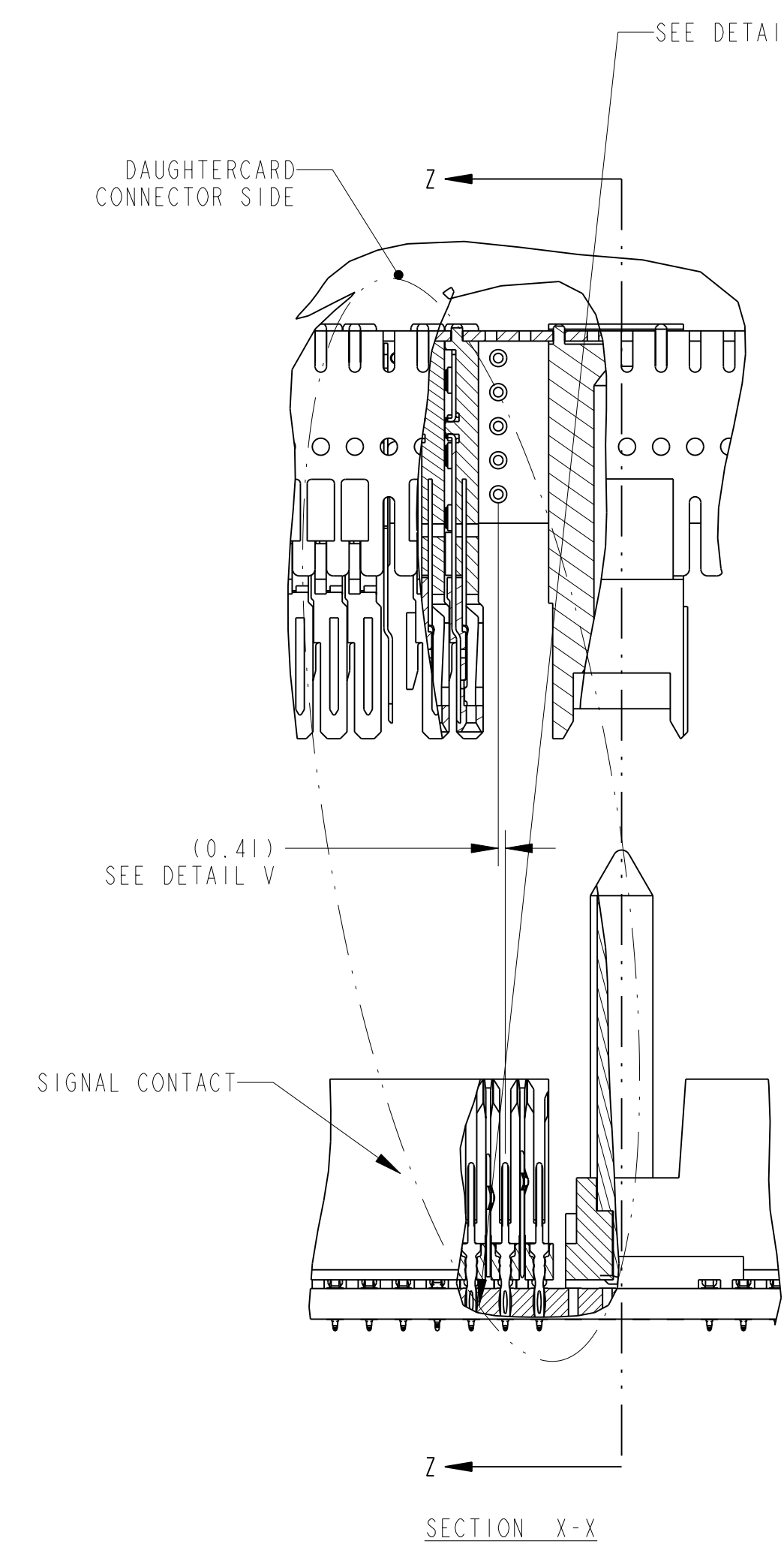
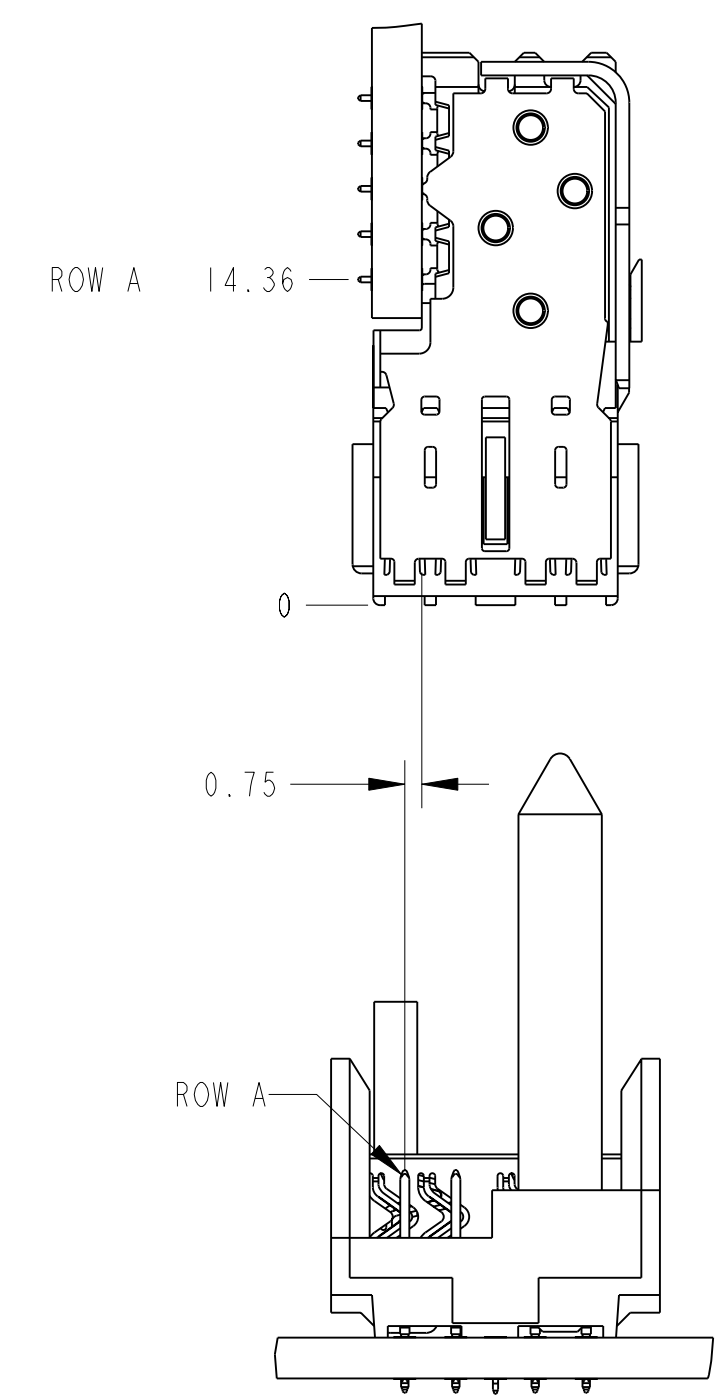

DETAIL V
SCALE 6/1

TOLERANCES	DESIGN	7/7/99
0.0	±0.25	D.Provencher
0.00	±0.13	
0.000	±	11/23/99 D.Provencher
ANGLES	±	4/27/00

Amphenol TCS
A Division of Amphenol Corporation
44 Simon Street, Nashua, NH, 03060 603.879.3000

TITLE
BACKPLANE POLARIZING/GUIDANCE M
ASSEMBLY, LEFT, 5 ROW VHDW-HSD

PART NO. SEE TABLE VI

DRAWING NO. C-467-5110-500

ProE ASSEM P1018-ASSY-BP-10-LEFTGUIDE-BRD 1.11
P1018-BP-LEFT-GUIDE-ASSY.dwg 1.45

SIZE D SCALE 3.000 SHEET 2 OF 2

INTERPRET PER ASME Y14.5M
CODE IDENT 31413

CUSTOMER USE
DRAWING